

**Our Case Number:** ACP-323972-25

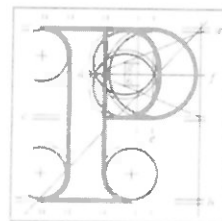

An  
Coimisiún  
Pleanála

Rachel Veenan Bucky  
Sean O'Carroll St  
Ardee  
Co. Louth  
A92 V260

**Date:** 12 February 2026

**Re:** Public realm and community infrastructure project on lands in Ardee, Co. Louth  
Ardee, Co. Louth

Dear Sir / Madam,

An Coimisiún Pleanála has received your recent submission in relation to the above mentioned proposed development and will take it into consideration in its determination of the matter. Please accept this letter as a receipt for the fee of €50 that you have paid.

Please note that the proposed development shall not be carried out unless the Commission has approved it or approved it with conditions.

If you have any queries in relation to the matter please do not hesitate to contact the undersigned officer of the Commission at [laps@pleanala.ie](mailto:laps@pleanala.ie)

Please quote the above mentioned An Coimisiún Pleanála reference number in any correspondence or telephone contact with the Commission.

Yours faithfully,

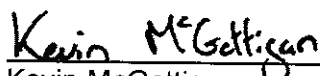

Kevin McGettigan  
Executive Officer  
Direct Line: 01-8737263

JA02

|                    |         |  |
|--------------------|---------|--|
| Teil               | Tel     | (01) 858 8100  |
| Glaio Áitiúil      | LoCall  | 1800 275 175   |
| Facs               | Fax     | (01) 872 2684  |
| Láithreán Gréasáin | Website | <a href="http://www.pleanala.ie">www.pleanala.ie</a>                       |
| Ríomhphost         | Email   | <a href="mailto:communications@pleanala.ie">communications@pleanala.ie</a> |

|                      |                       |
|----------------------|-----------------------|
| 64 Sráid Maoilbhríde | 64 Marlborough Street |
| Baile Átha Cliath 1  | Dublin 1              |
| D01 V902             | D01 V902              |

AN COIMISIUN PLEANALA

LDG- 086337-26

ACP-

27 JAN 2026

Fee: € 50 Type: P140

Time: 9.15 By: Reg. Post

An Coimisiun Pleanala,

Public Realm Section,

Ardee Co. Louth 2040 Plan – Reference No. ACP-323 972-25

I live in Sean O'Carroll St. A92V260 and the railway open space adjoins my boundary wall to rear of my property where the Louth Co. Council plans to plant new trees and replant existing trees.

I object to this plan for the following reasons:

I am planning on getting solar panels on the rear roof of my house facing southwards which enjoys sun light all day and the planting of trees would jeopardize the efficiency of these proposed panels as the trees grow higher.

My house insurance stipulates that there should be no trees in proximity to my house and I would be concerned about the planting of trees near my boundary especially after the recent storm Eowyn knocking down trees and branches and causing major damage to homes throughout the country.

I would also like to make an observation about the parking on Sean O'Carroll St. and the amount of traffic coming from the N33 through this street to the town centre and Midlouth Garage leaving no parking for anyone using the railway walk as it is, residents get it hard to park day or night.

A parking area of the proposed amenities should on Louth Co. Council land at the wastewater plant in Tierney St. where people could park their cars in comfort.

Trees could be planted on this area close to the Railway Walk where pitches and a running track are shown on the

**plan. Will this area be locked at night since the allotments on this plan will be securely protected by two locked gates at either end to prevent anti-social behaviour?**

**Attached please find 2 maps of the Railway Walk Carpark and my property marked in pink.**

**The second map of the proposed Railway Walk Carpark marked in brown linking the existing entrance to the Railway Walk from Tierney St. beside the Wastewater Treatment Plant.**

**Signed:**-----*Rachel Keenan Buckley*

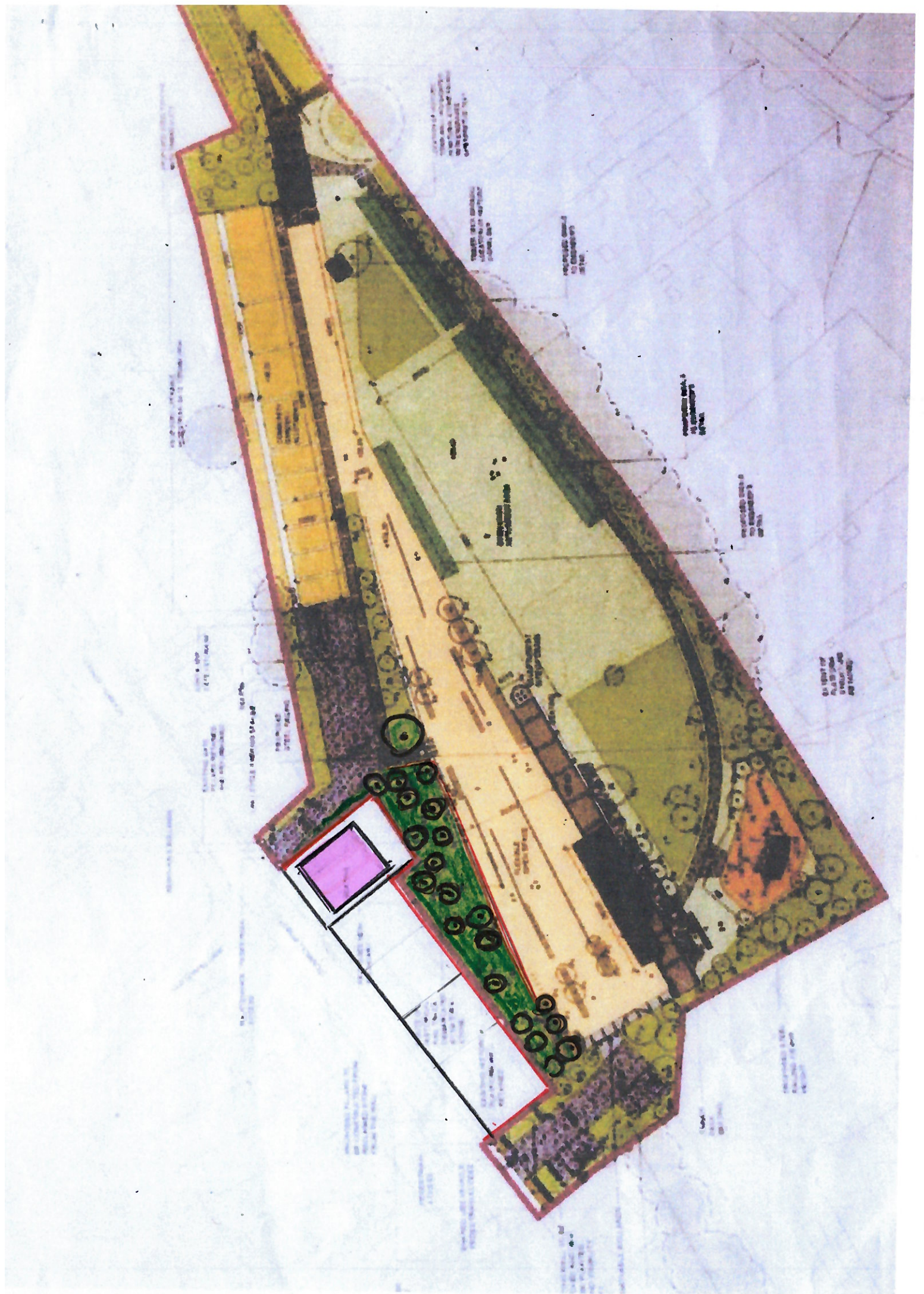

**Address:**-----*Sean O'Carroll's Street Ardara*

**Date:**-----*23-1-2026.*

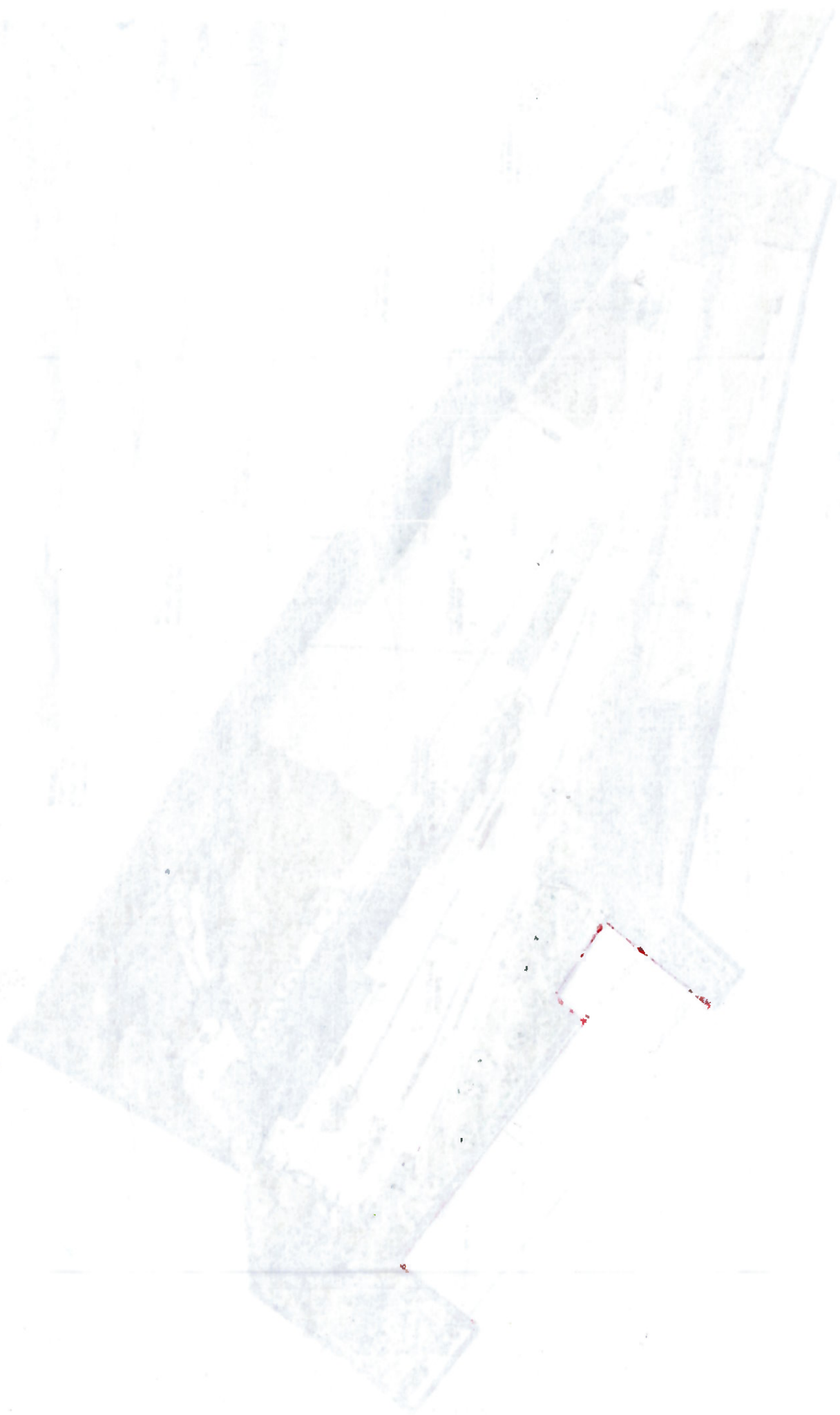

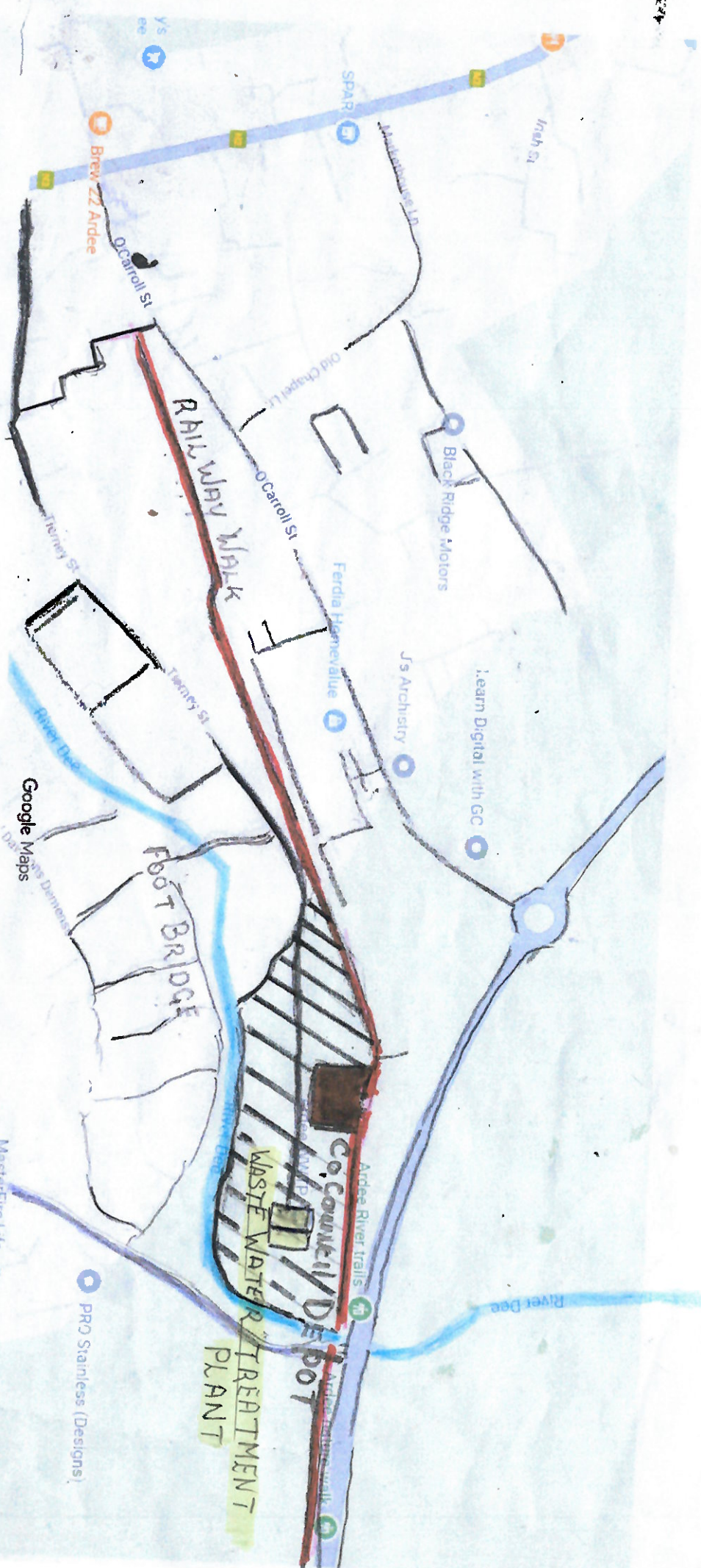



 LOUTH COUNCIL LAND  
 RAILWAY WALK CAR PARK  
 RAILWAY WALK